

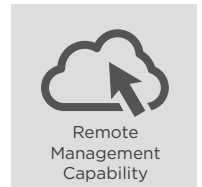

RELIABLE UPS TO PROTECT OFFICE EQUIPMENT

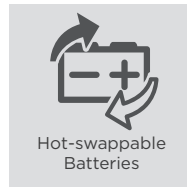
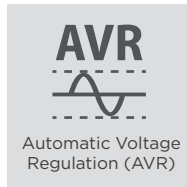
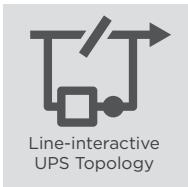

The line-interactive UPS with energy-saving technology for IT devices

Designed for office and server room applications, the Office Rackmount Series is a reliable UPS which adopts line-interactive topology with Automatic Voltage Regulation (AVR) function to offer stabilized AC power output. It features simulated sine wave output, and hot-swappable battery packs for simple maintenance. The power management software can also easily control and monitor the UPS system.

APPLICATION

- SOHO Office
- Back Office
- Supermarket
- Airport
- Office
- Server Room
- Factory
- Train Station

SERIES FEATURES

- Line-interactive UPS Topology
- Automatic Voltage Regulation (AVR)
- Surge and Spike Protection
- LCD Status Display
- SNMP/HTTP Remote Management Capability (Optional)
- Energy Saving Technology
- Hot-swappable Batteries
- Network Protection
- Overload Protection
- PowerPanel® Management Software

PRODUCT CALLOUTS

- 1 . Power On Indicator
- 2 . Power On/Off Switch
- 3 . LCD Display Panel
- 4 . Function Button(s)
- 5 . Battery Backup & Surge Protected Outlets
- 6 . Communication Protection Ports RJ45
- 7 . Input Circuit Breaker
- 8 . AC Inlet
- 9 . Serial Port
- 10 . USB Port
- 11 . SNMP/HTTP Network Slot

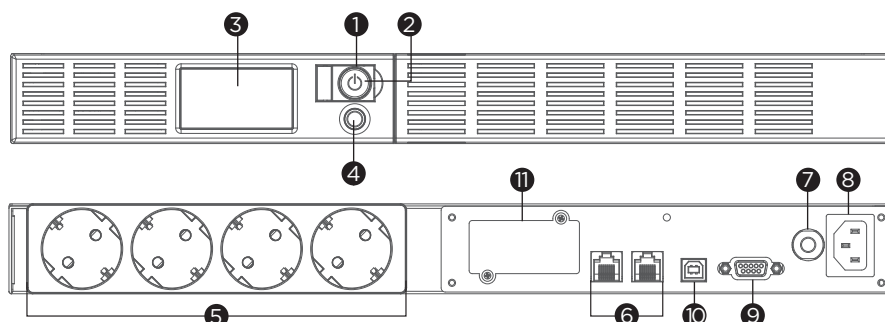

OR650ERM1UGR



TECHNICAL SPECIFICATIONS

Model Name	OR650ERM1UGR
General	
UPS Topology	Line-interactive
Energy Saving Technology	GreenPower UPS™ Bypass Technology
Input	
Nominal Input Voltage (Vac)	230
Input Voltage Range (Vac)	165 - 271
Input Frequency (Hz)	50 ± 3, 60 ± 3
Input Frequency Detection	Auto-sensing
Rated Input Current (A)	10
Input Connector Type	IEC C14
Output	
Capacity (VA)	650
Capacity (Watts)	360
On Battery Waveform	Simulated Sine Wave
On Battery Voltage(s) (Vac)	230 ± 10%
On Battery Frequency (Hz)	50 ± 1%, 60 ± 1%
Automatic Voltage Regulation (AVR)	Single Boost
Overload Protection	Internal Current Limiting, Circuit Breaker
Outlet(s) - Total	4
Outlet Type	Schuko x 4
Outlet(s) - Battery & Surge Protected	4
Typical Transfer Time (ms)	4
Battery	
Runtime at Half Load (min)	13
Runtime at Full Load (min)	4
Typical Recharge Time (Hours)	8
User Replaceable	Yes
Hot-Swappable	Yes
Battery Type	Sealed Lead-acid
Replacement Battery Pack	RBPO019
RBP Quantity (pcs)	1
Surge Protection & Filtering	
Surge Suppression (Joules)	405
EMI/RFI Filtration	Yes
Network Protection RJ45	1-in, 1-out
Management & Communications	
LCD Panel	Yes
HID Compliant USB Port(s)	1
Serial Port	Dry Contact
Power Management Software	PowerPanel® Business
SNMP/HTTP Remote Monitoring	Yes - with optional RMCARD205
Physical	
Form Factor	Rack
Physical Size - UPS Module	
Dimensions (WxHxD) (mm.)	433 x 44 x 235
Weight (kg.)	7.8
Installed Rack Height (U)	1
Environmental	
Operating Temperature (°C)	0 - 40
Operating Relative Humidity (Non-condensing) (%)	0 - 95
Online Thermal Dissipation (BTU/hr)	20
Certifications	
Certifications*	CE, EAC, RCM
RoHS	Yes

*Certifications may vary according to different regions. Visit www.cyberpower.com for more information.
 #All specifications are subject to change without notice.